

## CASE STUDY #1015

### External Cylindrical Grinding Machine

<b>Workpiece:</b>	Output Shaft
<b>Operation:</b>	OD & Face Grinding
<b>Machine:</b>	Micromatic SH-40 CNC
<b>Cycle Time:</b>	60 secs
<b>Stock Removal:</b>	0.3mm on OD & 0.15mm on face
<b>CpK:</b>	1.66 (for tolerance of 10 µm)
<b>Surface Roughness:</b>	02 ~ 0.3 µm Ra 1.65 ~ 2.67 Rz 0.5 ~ 1.25 Rpm
<b>Lead Angle:</b>	0± 0.05° as per SAEJ946
<b>Dressing Skip:</b>	5 components

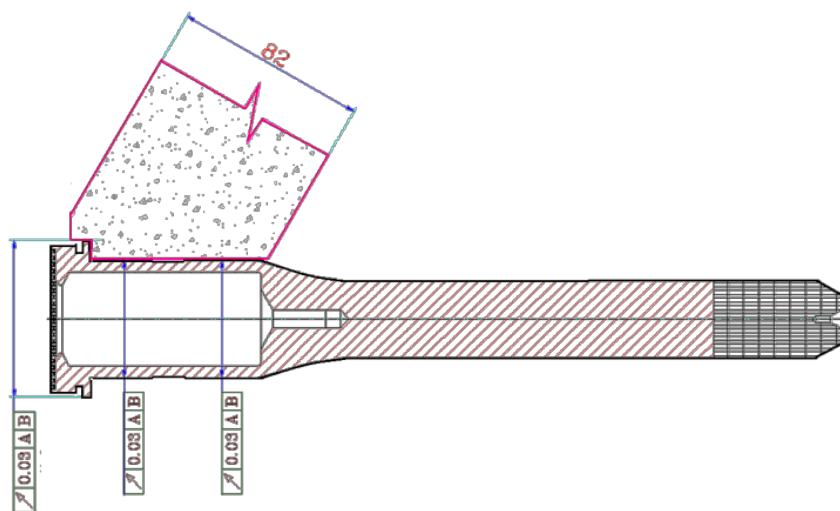

**SOLUTIONS FOR INDUSTRY**